**CHAPTER 8.
APPENDICES**

SPECIFICATIONS8-1
 GENERAL SPECIFICATIONS8-1
 MAINTENANCE SPECIFICATIONS8-4

GENERAL TORQUE SPECIFICATIONS8-13

DEFINITION OF UNITS8-13

CONVERSION TABLE8-14

CABLE ROUTING8-15

YFZ350T WIRING DIAGRAM



SPECIFICATIONS

APPENDICES

SPECIFICATIONS

GENERAL SPECIFICATIONS

Model	YFZ350T
Model Code Number	2GU
Engine Starting Number	2GU-000101
Vehicle Identification Number	JY42GU00*HC000101
DIMENSIONS:	
Overall Length	1,855 mm (73 in)
Overall Width	1,100 mm (43.3 in)
Overall Height	1,080 mm (42.5 in)
Seat Height	780 mm (30.7 in)
Wheelbase	1,280 mm (50.4 in)
Minimum Ground Clearance	135 mm (5.31 in)
BASIC WEIGHT:	
With Oil and Full Fuel Tank	182 kg (401 lb)
Minimum Turning Radius:	3,600 mm (142 in)
ENGINE:	
Engine Type	Liquid Cooled, 2-Stroke
Induction System	Reed Valve
Cylinder Arrangement	Forward Inclined Parallel 2-Cylinder
Displacement	347 cm ³
Bore × Stroke	64 × 54 mm (2.520 × 2.126 in)
Compression Ratio	6.5 : 1
Starting System	Kick Starter
LUBRICATION SYSTEM:	
Premix Ratio	Premix YAMALUBE "R" 24 : 1 CASTROL R30 20 : 1 CASTROL A545 20 : 1 CASTROL A747 20 : 1
Transmission Oil	SAE 10W30 type SE motor oil
OIL CAPACITY:	
Transmission Oil	
Periodic Oil Change	1.5 L (1.3 Imp qt, 1.6 US qt)
Total Amount	1.7 L (1.5 Imp qt, 1.8 US qt)
Radiator Capacity: (Including all Routes)	1.5 L (0.33 Imp gal, 0.40 US gal)
AIR FILTER:	Wet Type Element

SPECIFICATIONS

APPX



Model	YFZ350T	
FUEL: Type Capacity: Total Reserve Amount	Premix Premium Gasoline 12 L (2.64 Imp gal, 3.17 US gal) 2.5 L (2.2 Imp qt, 2.64 US qt)	
CARBURETOR: Type/Quantity Manufacturer	VM26SS/2 MIKUNI	
SPARK PLUG: Type Manufacturer Spark Plug Gap	B8ES/W24ES NGK/NIPPON DENSO 0.7 ~ 0.8 mm (0.028 ~ 0.032 in)	
Clutch Type	Wet, Multiple-disc	
TRANSMISSION: Primary Reduction System Primary Reduction Ratio Secondary Reduction System Secondary Reduction Ratio Transmission Type Operation Gear Ratio: 1st 2nd 3rd 4th 5th 6th	Helical Gear 66/23 (2.869) Chain Drive 42/13 (3.230) Constant Mesh 6-Speed Left Foot Operation 32/13 (2.461) 29/16 (1.812) 27/18 (1.500) 25/20 (1.250) 23/22 (1.045) 21/24 (0.875)	
CHASSIS: Frame Type Caster Angle Trail Tread (Standard): Rear Front Toe-in	Steel Tube Frame 9° 40 mm (1.57 in) 840 mm (33.1 in) 900 mm (35.4 in) 0 ~ 10 mm (0 ~ 0.39 in)	
TIRE: Type Size: Front Rear Wear Limit	Tubeless AT21 × 7-10 AT22 × 10-9 3 mm (0.12 in)	
TIRE PRESSURE:	Front	Rear
	30 kPa (0.3 kg/cm ² , 4.3 psi)	25 kPa (0.25 kg/cm ² , 3.6 psi)



Model	YFZ350T
BRAKE: Front Brake Type Front Brake Operation Rear Brake Type Rear Brake Operation Parking Brake Operation	Dual Disc Brake Right Hand Operation Single Disc Brake Right Foot Operation Left Hand Operation
SUSPENSION: Front Rear	Double Wishbone Swingarm (Link Suspension)
SHOCK ABSORBER: Front Rear	Coil Spring/Oil Damper Coil-Gas Spring/Oil Damper
WHEEL TRAVEL: Front Rear	220 mm (8.66 in) 220 mm (8.66 in)
ELECTRICAL: Ignition System Generator System Headlight Type Bulb Watage × Quantity: Headlight Tail/Brake Light	C.D.I. Flywheel Magneto Bulb Type 12V30W/30W × 2 12V3.8W/ – W × 1



MAINTENANCE SPECIFICATIONS

Engine

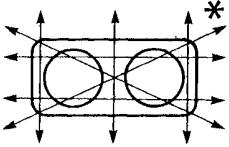
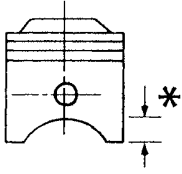
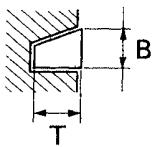
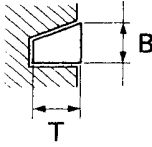
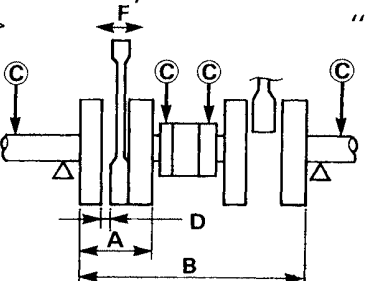
Model	YFZ350T
<p>CYLINDER HEAD: Warp Limit</p> 	<p>< 0.03 mm (0.0012 in) > *Lines indicate straightedge measurement:</p>
<p>CYLINDER: Bore Size < Limit > Taper Limit Out of Round Limit</p>	<p>64.00 ~ 64.02 mm (2.520 ~ 2.521 in) 64.1 mm (2.524 in) < 0.05 mm (0.002 in) > < 0.01 mm (0.0004 in) ></p>
<p>PISTON: Piston Size Measuring Point* Piston Clearance Oversize: 1st 2nd</p> 	<p>63.94 ~ 64.00 mm (2.517 ~ 2.520 in) 10 mm (0.39 in) 0.060 ~ 0.065 mm (0.0024 ~ 0.0026 in) 64.25 mm (2.53 in) 64.50 mm (2.54 in)</p>
<p>PISTON RING: TOP RING: Type Dimensions (B x T) End Gap (Installed) < Limit > Side Clearance (Installed) < Limit > 2ND RING: Type Dimensions (B x T) End Gap (Installed) < Limit > Side Clearance < Limit ></p>  	<p>Keystone 1.2 x 2.6 mm (0.05 x 0.10 in) 0.30 ~ 0.45 mm (0.012 ~ 0.018 in) < 0.5 mm (0.020 in) > 0.02 ~ 0.06 mm (0.0008 ~ 0.0024 in) < 0.12 mm (0.0047 in) > Keystone 1.50 x 2.15 mm (0.06 x 0.08 in) 0.30 ~ 0.45 mm (0.012 ~ 0.018 in) < 0.5 mm (0.020 in) > 0.02 ~ 0.06 mm (0.0008 ~ 0.0024 in) < 0.12 mm (0.0047 in) ></p>
<p>CRANKSHAFT: Crank Width "A" Assembly Width "B" Runout Limit "C" Big End Side Clearance "D" Small End Free Play "E" < Limit > "F"</p> 	<p>53.95 ~ 54.00 mm (2.124 ~ 2.126 in) 155.90 ~ 156.05 mm (6.138 ~ 6.144 in) < 0.05 mm (0.0021 in) > 0.25 ~ 0.75 mm (0.0098 ~ 0.0295 in) 0.36 ~ 0.98 mm (0.0142 ~ 0.0386 in) < 2.0 mm (0.08 in) ></p>



Model	YFZ350T
CLUTCH: Friction Plate: Thickness Quantity Wear Limit Clutch Plate: Thickness Quantity Warp Limit Clutch Spring: Free Length Quantity Minimum Length Clutch Release Method Push rod bending limit	3 mm (0.118 in) 7 pcs <2.7 mm (0.106 in) > 1.2 mm (0.047 in) 6 pcs <0.05 mm (0.002 in) > 36.4 mm (1.43 in) 6 pcs 34.4 mm (1.351 in) Inner Push, Cam Push <0.2 mm (0.008 in) >
TRANSMISSION: Main Axle Deflection Limit Drive Axle Deflection Limit	<0.08 mm (0.0031 in) > <0.08 mm (0.0031 in) >
SHIFTER: Shifter Type	Cam Drum
KICK STARTER: Kick Starter Type Kick clip Friction Force Air Filter Oil Grade	Kick & Mesh Type 0.8~1.3 kg (1.8~2.9 lb) Foam-Air-Filter Oil or SAE10W30SE type motor oil
CARBURETOR: I.D. Mark Fuel Level (F.L.) (With Special Tool) Float Height (F.H.) Main Jet (M.J.) Main Air Jet (M.A.J.) Jet Needle (J.N.) Needle Jet (N.J.) Cutaway (C.A.) Pilot Outlet (P.O.) Pilot Jet (P.J.) Bypass 1 (B.P.1.) Air Screw (A.S.) Valve Seat Size (V.S.) Starter Jet (G.S.)	2GU 00 0.5~1.5 mm (0.020~0.059 in) 20~22 mm (0.80~0.88 in) #210 φ1.6 5N7-3 O-8 2.0 φ0.6 #25 1.4 2.0 turns out 2.8 φ1.4
REED VALVE: Thickness Valve Stopper Height Valve Bending Limit	0.37~0.47 mm (0.0146~0.0185 in) 10.3~10.7 mm (0.406~0.421 in) <0.5 mm (0.02 in) >

SPECIFICATIONS





APPX



Model	YFZ350T
COOLING SYSTEM: Radiator Core Size: Width Height Thickness Radiator Cap Opening Pressure Reservoir Tank Capacity Water Pump Type	210 mm (8.27 in) 350 mm (13.8 in) 32 mm (1.26 in) 93 ~ 123 kPa (0.95 ~ 1.25 kg/cm ² , 13.5 ~ 17.8 psi) 0.28 L (0.246 Imp qt, 0,296 US, qt) Single-Suction Centrifugal Pump



Tightening torque

Part to be tightened	Thread size	Tightening torque			Remarks
		Nm	m•kg	ft•lb	
Cylinder head	M 8×1.25	28	2.8	20	
Cylinder	M 8×1.25	28	2.8	20	
Spark plug	M14×1.25	20	2.0	14	
Reed valve	M 3×0.5	1	0.1	0.7	
Water pump cover	M 6×1.0	8	0.8	5.8	
Joint (Cylinder head)	M 6×1.0	12	1.2	8	
Reed valve assembly	M 6×1.0	10	1.0	7.2	
Primary drive gear	M16×1.0	65	6.5	47	
Clutch boss	M20×1.0	90	9.0	65	
Clutch spring	M 6×1.0	10	1.0	7.2	
Drive sprocket	M18×1.0	80	8.0	58	
Kick crank	M 8×1.25	25	2.5	18	
Shift pedal	M 6×1.0	14	1.4	10	
Flywheel magneto	M12×1.25	80	8.0	58	
Exhaust pipe	M 8×1.25	25	2.5	18	
Silencer	M 8×1.25	35	3.5	25	
Drain plug (Transmission)	M14×1.5	20	2.0	14	
(Coolant)	M 6×1.0	14	1.4	10	
Crankcase cover (R)	M 6×1.0	7	0.7	5.1	
(L)	M 6×1.0	7	0.7	5.1	
Crankcase (Lower)	M 8×1.25	25	2.5	18	
(Upper)	M 6×1.0	10	1.0	7.2	
Bearing stopper plate	M 6×1.0	14	1.4	10	
Shift cam stopper plate	M 6×1.0	14	1.4	10	
Stopper lever	M 6×1.0	10	1.0	7.2	
Shift lever adjust screw	M 8×1.25	30	3.0	22	



SPECIFICATIONS

Chassis

Model	YFZ350T
STEERING SYSTEM: Lock to Lock Angle: Left Right	38.0° 38.0°
FRONT SUSPENSION: Cushion stroke Suspension Spring Free Length Spring Rate (K1) (K2) Stroke (K1) (K2)	110 mm (4.33 in) 279.5 mm (11 in) 34.3 N/mm (3.5 kg/mm, 196 lb/in) 39.2 N/mm (4.0 kg/mm, 224 lb/in) Zero ~ 59.5 mm (Zero ~ 2.34 in) 59.5 ~ 127.0 mm (2.34 ~ 5.00 in)
REAR SUSPENSION: Shock Absorber Travel Spring Free Length Fitting Length Spring Rate (K1) Stroke (K1)	86 mm (3.39 in) 234.5 mm (9.23 in) 218.5 mm (8.6 in) 63.7 N/mm (6.5 kg/mm, 364 lb/in) 0 ~ 124.5 mm (0 ~ 4.90 in)
REAR ARM: Swing Arm Free Play Limit: End Side	< 1 mm (0.04 in) > < 1 mm (0.04 in) >
FRONT WHEEL: Type Rim Size Rim Material Rim Runout Limit: Vertical Lateral	Panel Wheel 10×6 AT Aluminum < 2 mm (0.08 in) > < 2 mm (0.08 in) >
REAR WHEEL: Type Rim Size Rim Material Rim Runout Limit: Vertical Lateral	Panel Wheel 9×8.5 AT Aluminum < 2 mm (0.08 in) > < 2 mm (0.08 in) >
DRIVE CHAIN: Type/Manufacturer No. of Links Chain Free Play	520V/DAIDO 103+ Joint 15 mm (0.6 in)
FRONT DISC BRAKE: Type Disc Outside Dia. × Thickness Pad Thickness < Limit > Master Cylinder Inside Diameter Caliper Cylinder Inside Diameter Brake Fluid Type	Dual 161.0×3.5 mm (6.34×0.138 in) 6 mm (0.24 in) < 0.8 mm (0.032 in) > 14 mm (0.55 in) 31.75 mm (1.25 in) DOT No. 4



Model	YFZ350T
REAR DISC BRAKE: Type Disc Outside Dia. × Thickness Pad Thickness Inner < Limit > Pad Thickness Outer < Limit > Master Cylinder Inside Diameter Caliper Cylinder Inside Dia. Brake Fluid Type	Single 220.0 × 3.5 mm (8.66 × 0.138 in) 4.5 mm (0.18 in) < 1 mm (0.039 in) > 4.5 mm (0.18 in) < 1 mm (0.039 in) > 12.7 mm (0.50 in) 33.96 mm (1.34 in) DOT No. 4
BRAKE LEVER AND BRAKE PEDAL: Brake Lever Free Play Brake Pedal Position Brake Pedal Free Play	4~8 mm (0.16~0.32 in) at lever end 10 mm (0.4 in) 8 mm (0.3 in)

Tightening torque

Part to be tightened	Thread size	Tightening torque			Remarks
		Nm	m•kg	ft•lb	
Steering knuckle & Castle nut	M14×1.5	85	8.5	61	
Wheel panel nut	M10×1.25	45	4.5	32	
Steering knuckle & Knuckle arm	M10×1.25	38	3.8	27	
Caliper (Front)	M 8×1.25	28	2.8	20	
Brake disc (Front & Rear)	M 8×1.25	28	2.8	20	
Steering knuckle & Ball joint	M10×1.25	25	2.5	18	
Ball joint (Tie-rod) & Knuckle arm	M10×1.25	25	2.5	18	
Ball joint (Tie-rod) & Steering shaft	M10×1.25	25	2.5	18	
Ball joint & Tie-rod	M10×1.25	30	3.0	22	
Steering shaft & Frame	M10×1.25	30	3.0	22	
Steering bearing bracket & Frame	M 8×1.25	23	2.3	17	Use lock washer
Handlebar holder	M 8×1.25	20	2.0	14	
Bearing holder (Steering shaft)	M42×1.0	40	4.0	29	
Upper & Lower arm & Frame	M10×1.25	30	3.0	22	
Front shock absorber (Upper & Lower)	M10×1.25	45	4.5	32	
Engine mount:					
Frame & Front engine stay	M 8×1.25	30	3.0	22	
Engine & Front engine stay	M10×1.25	45	4.5	32	
Engine & Rear engine stay	M10×1.25	45	4.5	32	
Tension rod & Engine	M10×1.25	25	2.5	18	
Tension rod & Tension rod stay	M10×1.25	45	4.5	32	
Tension rod stay & Frame	M10×1.25	45	4.5	32	
Pivot shaft	M16×1.5	85	8.5	61	
Rear shock absorber (Upper & Lower)	M10×1.25	30	3.0	22	
Relay arm & Frame	M10×1.25	30	3.0	22	
Connecting rod & Swingarm	M10×1.25	30	3.0	22	
Relay arm & connecting rod	M10×1.25	30	3.0	22	
Footrest	M10×1.25	55	5.5	40	
Caliper (Rear)	M 8×1.25	23	2.3	17	
Rear axle ring nut	M33×1.5	—	—	—	SEE NOTE
Rear axle & Castle nut	M14×1.5	120	12.0	85	
Rear hub & Swingarm (Upper)	M12×1.25	120	12.0	85	
(Lower)	M10×1.25	60	6.0	43	
Brake hose union bolt	M10×1.25	25	2.5	18	
Brake hose & Caliper	M10×1.25	25	2.5	18	
Brake hose joint & Brake pipe	M10×1.0	18	1.8	13	
Brake hose joint	M 8×1.25	20	2.0	14	
Rear master cylinder	M 8×1.25	20	2.0	14	
Driven sprocket	M10×1.25	60	6.0	43	
Chain puller & Locknut	M 8×1.25	16	1.6	11	
Locknut (Rear brake caliper adjustment)	M 8×1.25	16	1.6	11	
Swingarm & Swingarm guard	M 8×1.25	23	2.3	17	

NOTE:

1. Tighten the inside-ring nut to 130 Nm (13.0 m•kg, 94 ft•lb) while holding the rear axle.
2. Hold the inside-ring nut and tighten the outside-ring nut to 190 Nm (19.0 m•kg, 140 ft•lb).
3. Hold the outside-ring nut and tighten back the inside-ring nut to 240 Nm (24.0 m•kg, 170 ft•lb).



MAINTENANCE SPECIFICATION (ELECTRICAL)

Modèl	YFZ350T
Voltage	12V
IGNITION SYSTEM: Ignition Timing (B.T.D.C.) Advancer Type	17°/1,200 r/min Electrical Type
C.D.I.: Magneto Model/Manufacturer Pickup Coil Resistance (Color) Charging Coil Resistance (Color) C.D.I. Unit Model/Manufacturer	032000-620/NIPPONDENSO 94 ~ 140Ω at 20°C (68°F) (W/R—W/G) 13.7 ~ 20.5Ω at 20°C (68°F) (G—R) 070000-167/NIPPONDENSO
IGNITION COIL: Model/Manufacturer Minimum Spark Gap Primary Winding Resistance Secondary Winding Resistance	129700-146/NIPPONDENSO 6 mm (0.24 in) 0.28 ~ 0.38Ω at 20°C (68°F) 4.7 ~ 7.1kΩ at 20°C (68°F)
SPARK PLUG CAP: Type Resistance	Rubber Type 5kΩ
F.W.MAGNETO: Model/Manufacturer Lighting Voltage (Min.) (Max.) Lighting Coil Resistance (Color)	032000-620/NIPPONDENSO 11.5V/2,500 r/min 16.3V/8,000 r/min 0.26 ~ 0.38Ω at 20°C (68°F) (Y—B)

SPECIFICATIONS

APPX



Model	YFZ350T
VOLTAGE REGULATOR: Model/Manufacturer	TRIZ-50/HITACHI
No Load Regulated Voltage	16V
Withstand Voltage	200V



GENERAL TORQUE SPECIFICATIONS

This chart specifies torque for standard fasteners with standard I.S.O. pitch threads. Torque specifications for special components or assemblies are included in the applicable sections of this book. To avoid warpage, tighten multi-fastener assemblies in a crisscross fashion, in progressive stages, until full torque is reached. Unless otherwise specified, torque specifications call for clean, dry threads. Components should be at room temperature.

A (Nut)	B (Bolt)	General torque specifications		
		Nm	m·kg	ft·lb
10 mm	6 mm	6	0.6	4.3
12 mm	8 mm	15	1.5	11
14 mm	10 mm	30	3.0	22
17 mm	12 mm	55	5.5	40
19 mm	14 mm	85	8.5	61
22 mm	16 mm	130	13.0	94

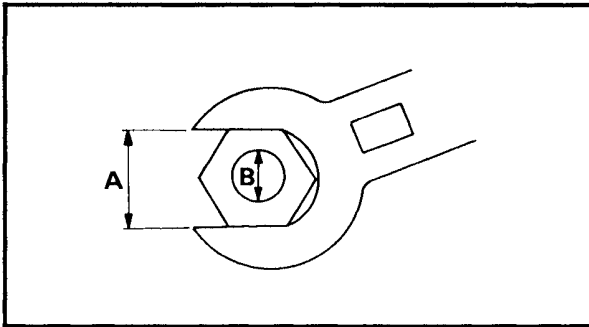

- A** Distance across flats
- B** Outside thread diameter

DEFINITION OF UNITS

Unit	Read	Definition	Measure
mm	millimeter	10^{-3} meter	Length
cm	centimeter	10^{-2} meter	Length
kg	kilogram	10^3 gram	Weight
N	Newton	$1 \text{ kg} \times \text{m}/\text{sec}^2$	Force
Nm	Newton meter	$\text{N} \times \text{m}$	Torque
m·kg	Meter kilogram	$\text{m} \times \text{kg}$	Torque
Pa	Pascal	N/m^2	Pressure
N/mm	Newton per millimeter	N/mm	Spring rate
L	Liter		Volume or Capacity
cm^3	Cubic centimeter		Volume or Capacity
r/min	Rotation per minute		Engine Speed

CONVERSION TABLES



CONVERSION TABLES

Metric to inch system		
Known	Multiplier	Result
m•kg	7.233	ft•lb
m•kg	86.80	in•lb
cm•kg	0.0723	ft•lb
cm•kg	0.8680	in•lb
kg	2.205	lb
g	0.03527	oz
km/lit	2.352	mpg
km/hr	0.6214	mph
km	0.6214	mi
m	3.281	ft
m	1.094	yd
cm	0.3937	in
mm	0.03937	in
cc (cm ³)	0.03382	oz (US liq)
cc (cm ³)	0.06102	cu in
lit (liter)	2.1134	pt (US liq)
lit (liter)	1.057	qt (US liq)
lit (liter)	0.2642	gal (US liq)
kg/mm	56.007	lb/in
kg/cm	14.2234	psi (lb/in)
Centigrade (°C)	9/5 (°C) + 32	Fahrenheit (°F)

Inch to metric system		
Known	Multiplier	Result
ft•lb	0.13862	m•kg
in•lb	0.01152	m•kg
ft•lb	13.831	cm•kg
in•lb	1.1521	cm•kg
lb	0.4535	kg
oz	28.352	g
mpg	0.4252	km/lit
mph	1.609	km/hr
mi	1.609	km
ft	0.3048	m
yd	0.9141	m
in	2.54	cm
in	25.4	mm
oz (US liq)	29.57	cc (cm ³)
cu in	16.387	cc (cm ³)
pt (US liq)	0.4732	lit (liter)
qt (US liq)	0.9461	lit (liter)
gal (US liq)	3.785	lit (liter)
lb/in	0.017855	kg/mm
psi (lb/in)	0.07031	kg/cm
Fahrenheit (°C)	5/9 (F°-32)	Centigrade (°F)

CABLE ROUTING

- ① Throttle switch lead
- ② Throttle cable
- ③ Fuel tank breather hose
- ④ Band
- ⑤ Parking brake cable
- ⑥ Clutch cable
- ⑦ Front brake hose
- ⑧ Clamp
- ⑨ Breather hose

- A** Pass the cable in front of the front brake pipe.
- B** Pass the cables behind the front brake pipe.
- C** Pass the hose through the handle protector hole.
- D** Clamp the hoses.
- E** Pass the hoses through the hose guide.

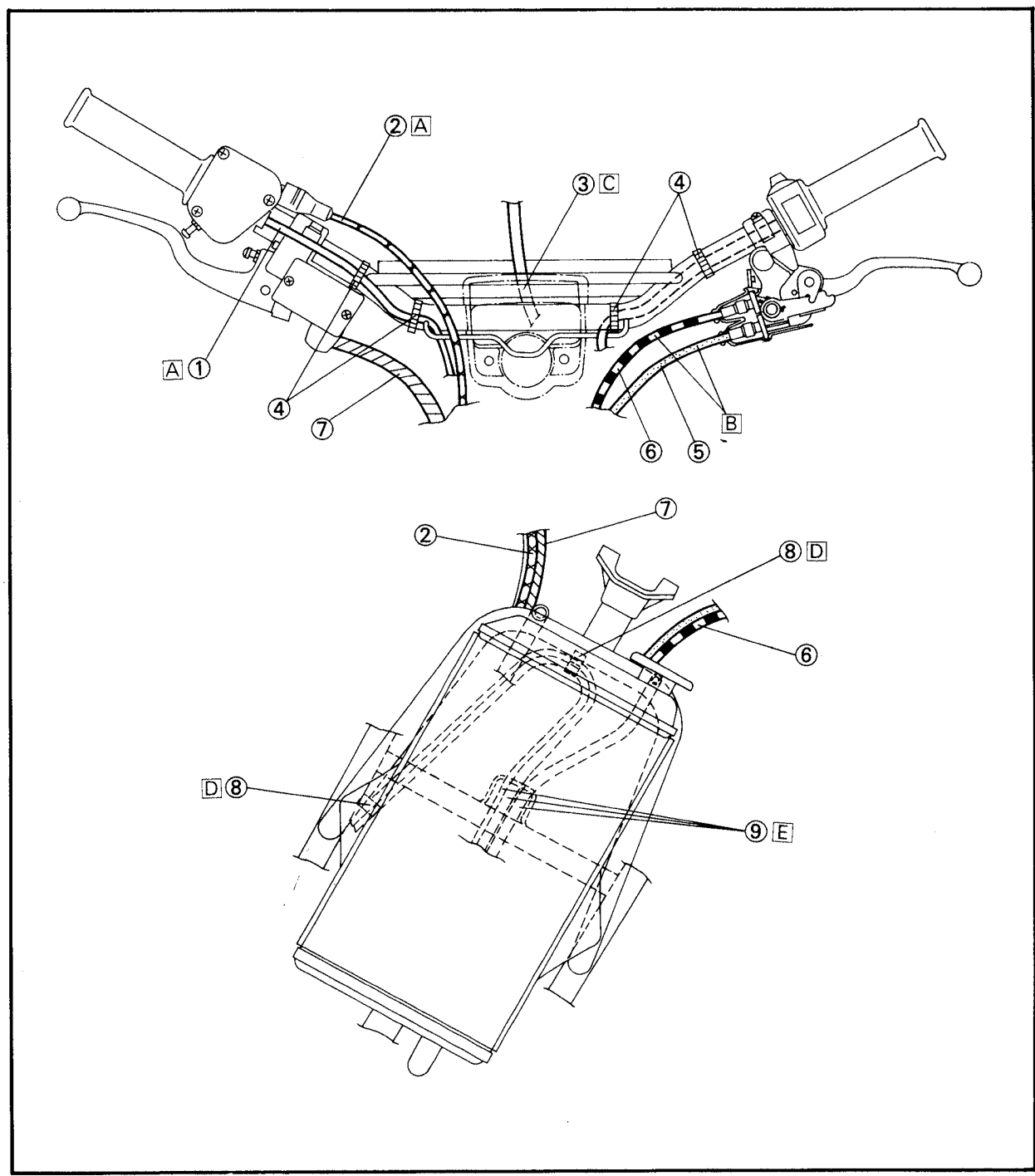



CABLE ROUTING

- ① Main switch
- ② Wire harness
- ③ Fuel hose
- ④ Crankcase breather hose
- ⑤ Carburetor over flow hose
- ⑥ Radiator hose
- ⑦ Throttle switch lead
- ⑧ Handle switch lead.

- Ⓐ Pass the wire harness into the guide. Align the marking tape at the position of the guide.
- Ⓑ Pass the hose into the guide
- Ⓒ Do not pass the hose into the guide. Pass the hose behind the brake pipe.

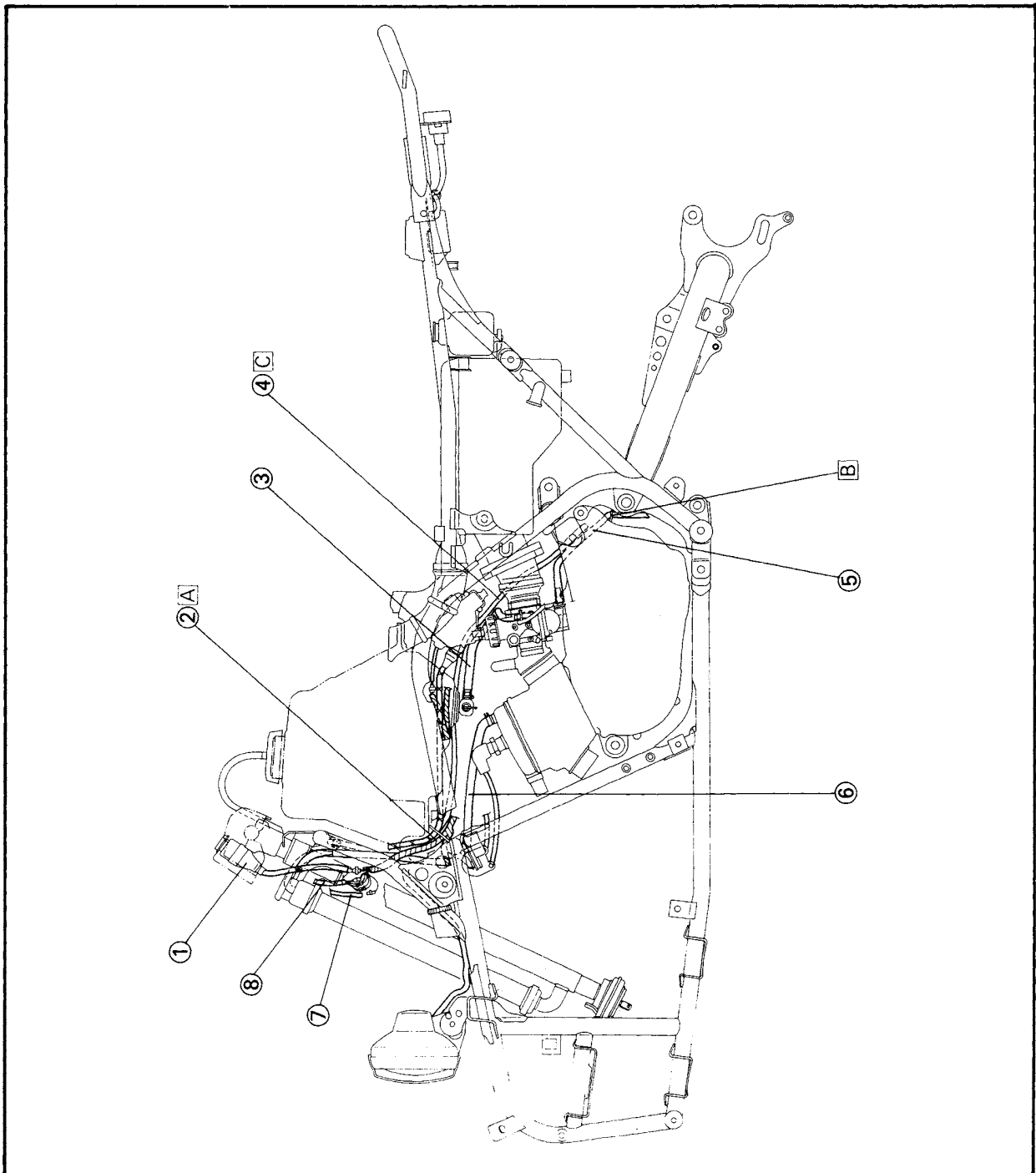



CABLE ROUTING

- ① Carburetor switch lead
- ② Throttle cable
- ③ Band
- ④ Clutch cable
- ⑤ Parking brake cable
- ⑥ Breather hose
- ⑦ Cable guide
- ⑧ CDI magneto lead
- ⑨ Wire harness
- ⑩ Clamp

- A Pass the wire harness and hoses through the guide on the air cleaner.
- B Pass the lead above the hoses and cables.
- C Pass the cable through the guide.
- D Route the hose behind the clutch and Parking cable. Pass the hose between both carburetor joint.
- E Route the cable behind the rear brake hose.
- F Pass the hoses inside the wire harness.

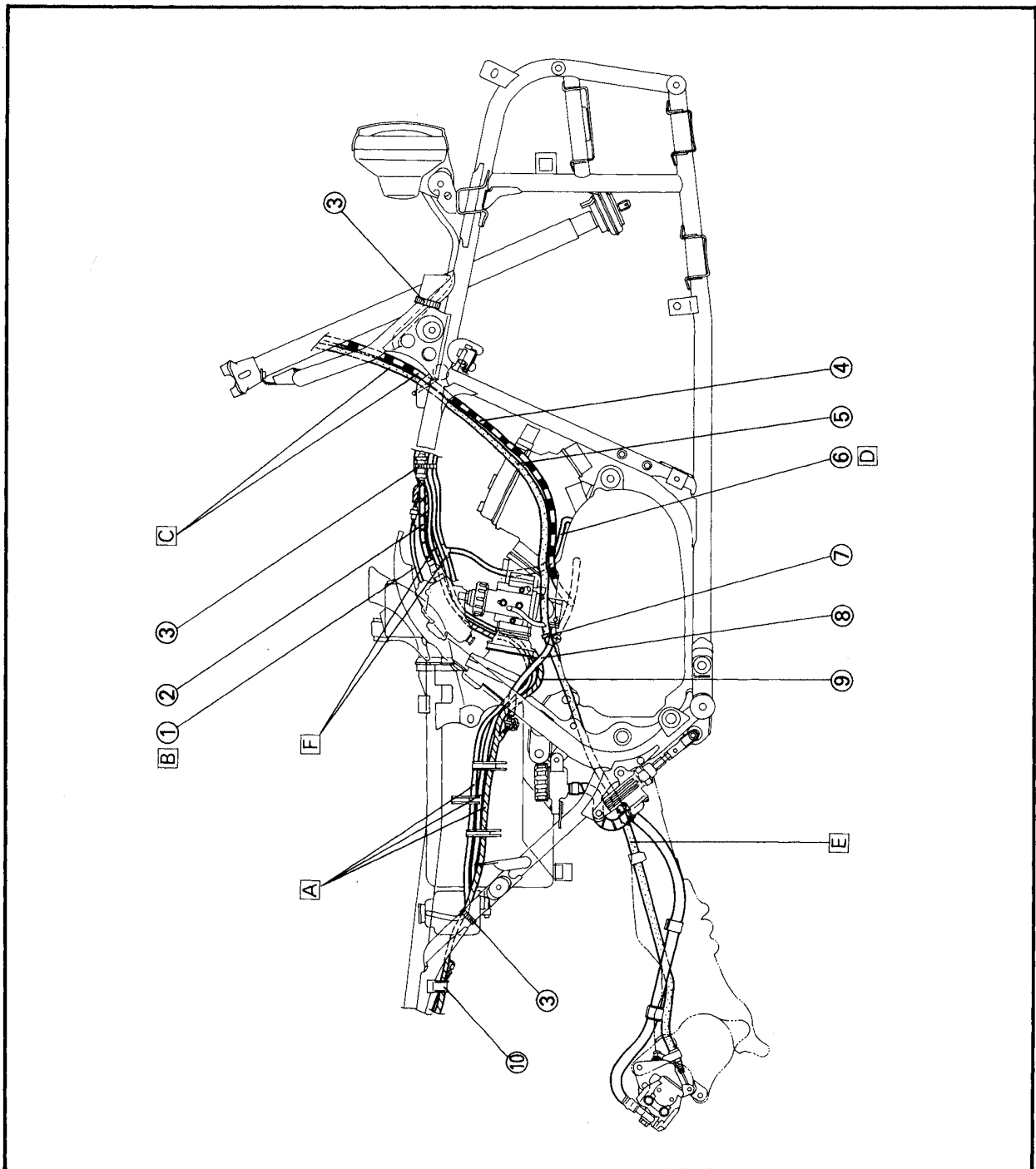

CABLE ROUTING

- ① Headlight
 - ② Ignition coil
 - ③ Wire harness
 - ④ Reserver tank
 - ⑤ Voltage regulator
 - ⑥ Body earth
 - ⑦ Clamp
 - ⑧ CDI unit
 - ⑨ Carburetor switch lead
 - ⑩ T.O.R.S. control unit
- A Ignition coil lead (Orange)
 - B Ignition coil lead (Black)

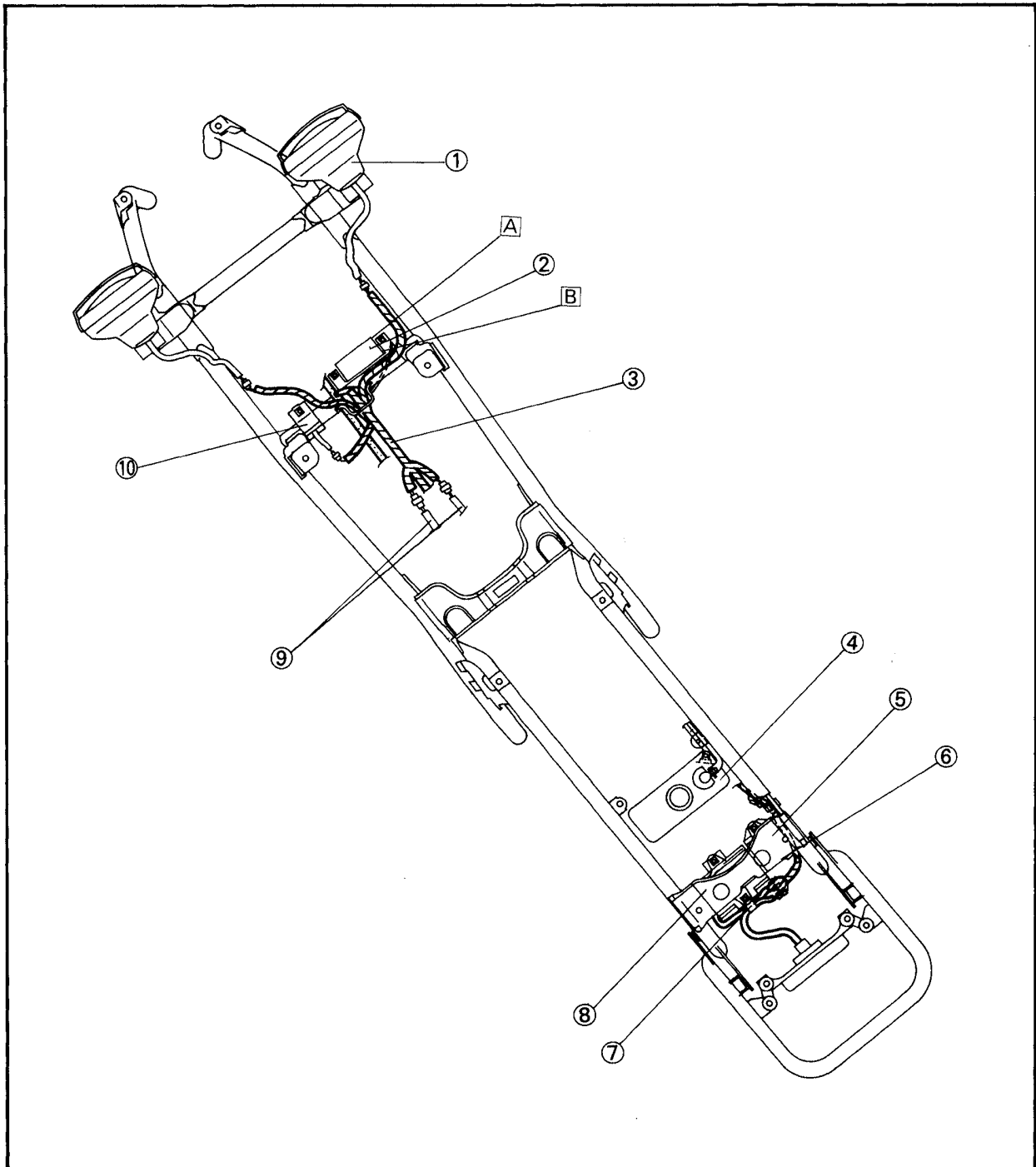

YFZ350T WIRING DIAGRAM

- ① T.O.R.S. control unit
- ② Carburetor switch
- ③ Voltage regulator
- ④ Taillight
- ⑤ Spark plug
- ⑥ Ignition coil
- ⑦ CDI unit
- ⑧ CDI magneto
- ⑨ Headlight
- ⑩ Main switch
- ⑪ "ENGINE STOP" switch
- ⑫ "LIGHTS" (Dimmer) switch
- ⑬ Throttle switch
- ⑭ Headlight

COLOR CODE

B	Black	B/W	Black/White
Br	Brown	B/Y	Black/Yellow
G	Green	R/B	Red/Black
L	Blue	W/G	White/Green
O	Orange	W/R	White/Red
R	Red	W/B	White/Black
Y	Yellow	Y/B	Yellow/Black
B/R	Black/Red	Y/R	Yellow/Red

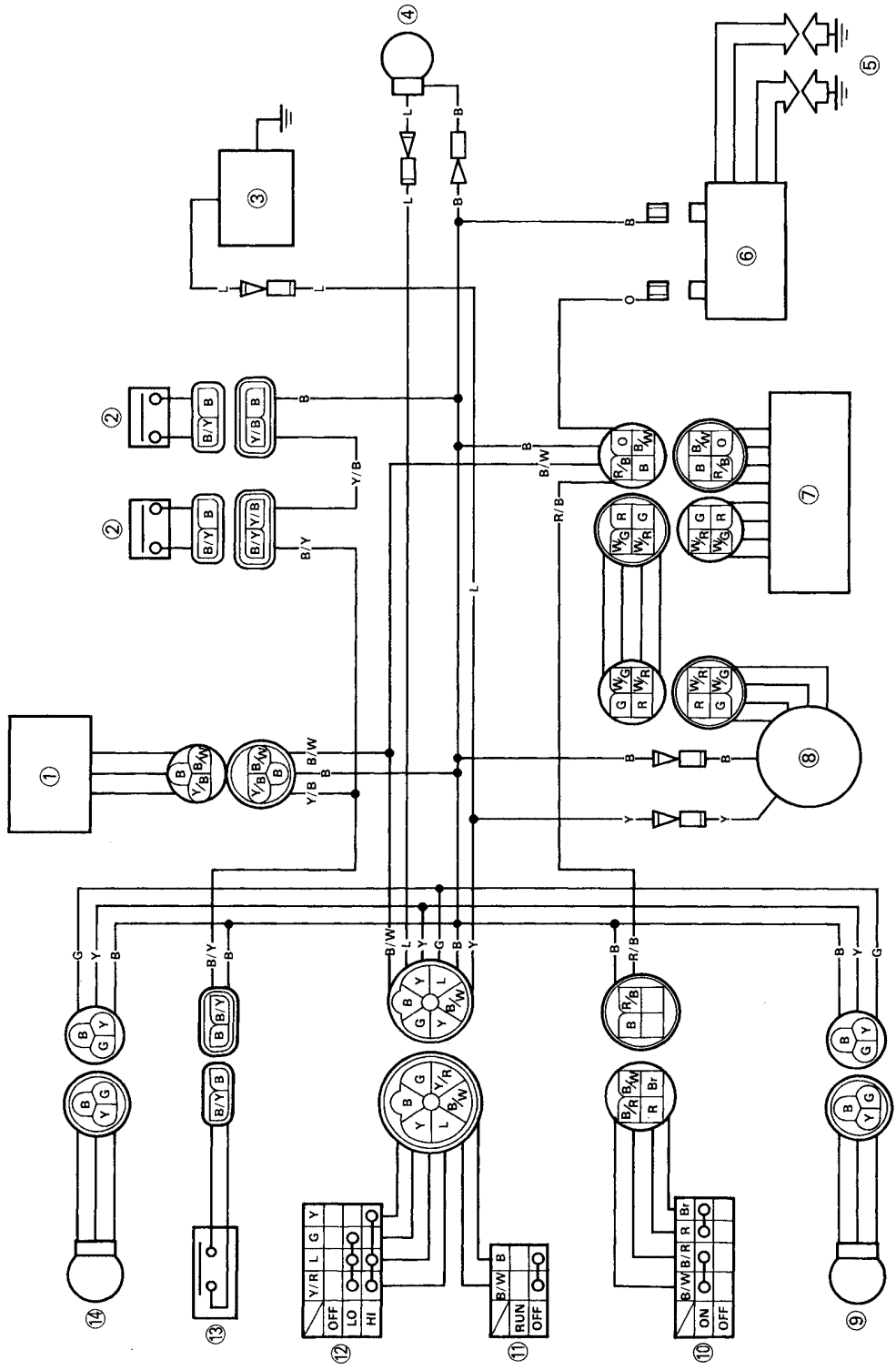



YAMAHA MOTOR CO.,LTD.

IWATA, JAPAN

PRINTED IN U.S.A.

PROTECT YOUR INVESTMENT
Use Genuine YAMAHA Parts And Accessories



LIT-11616-YF-36

YAMAHA MOTOR CORPORATION, U.S.A.
PRINTED IN U.S.A.